

W. ELM STREET

N. MAIN STREET



EXISTING SITE

DESCRIPTION OF PROPOSED SIGNS (SMALLER CANOPY SIGNS):

TYPE	SIGN COPY	DIMENSIONS	AREA
① Pole Sign	Price/ID	6'-0" x 5'-0"	30.00 sq. ft.
② Canopy Sign	Dino	1'-10" x 3'-6"	03.00 sq. ft.
③ Canopy Sign	Dino	1'-10" x 3'-6"	03.00 sq. ft.
④ Canopy Sign	Sinclair	1'-9" x 6'-2"	10.80 sq. ft.
⑤ Building Sign	Dino Mart	1'-10" x 11'-8"	20.16 sq. ft.

TOTAL PROPOSED SIGN AREA: 67.76 sq. ft.

55 SF

SITE PLAN
SCALE: 1/32" = 1'-0"



Sign Development Inc.

License #576277

Upland, CA 91786 (909) 920-5535

PROPRIETARY INFORMATION. The information disclosed in this document, including all drawings, designs and related materials, is the valuable and proprietary information of Sign Development Inc. It is provided solely for the purpose of evaluation for purchase and, without the express written authorization of Sign Development Inc., may not be disclosed or duplicated, in whole or in part, for any reason. Sign Development Inc. expressly reserves all patent, copyright and other proprietary rights to this document, including all design, manufacturing, reproduction, use, and sales rights thereto. © 2011 SIGN DEVELOPMENT INC.

CUSTOMER APPROVAL

SIGN AND PRINT FULL NAME

DATE

NO. T4820

PAGE: 1 OF 5

DATE: 02.13.18SM

REV: 03.05.18GO 03.16.18GO



863 N. MAIN ST.
FORT BRAGG, CA 95437

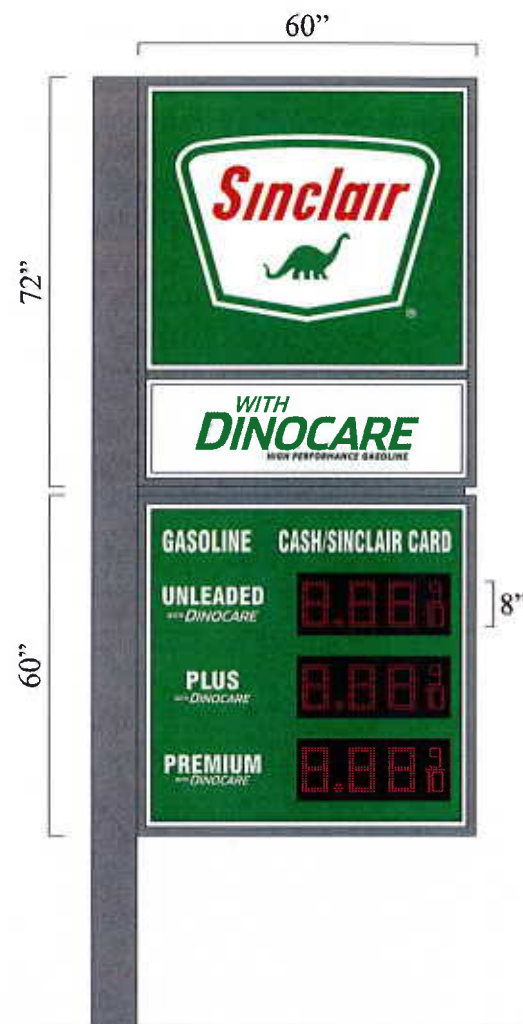

PAINT EXISTING CABINETS AND
POLE STRUCTURES CHARCOAL GRAY.
BY OWNER.

- ① REFACE EXISTING D/F PRICE/ID SIGN.
30 sq.ft.

SCALE: 1/4" = 1'-0"



EXISTING SITE
30 sq.ft.

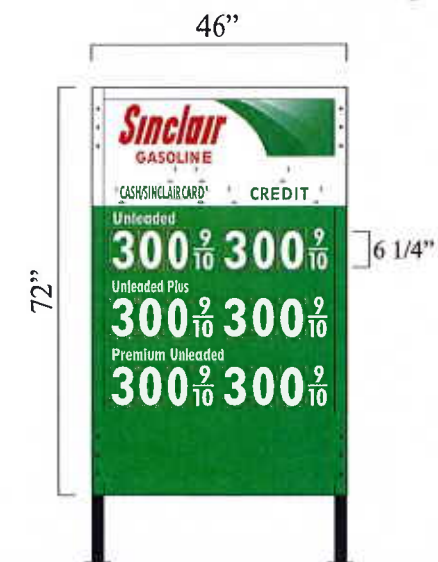

THERE MUST BE A PAD SIGN CLEARLY POSTING
THE CREDIT PRICE AND LOCATED AT OR NEAR
THE BASE OF THE MAIN ID WHERE IT IS CLEARLY
VISIBLE TO THE CONSUMER



Sign Development Inc.

License #576277

Upland, CA 91786 (909) 920-5535

PROPRIETARY INFORMATION. The information disclosed in this document, including all drawings, designs and related materials, is the valuable and proprietary information of Sign Development Inc. It is provided solely for the purpose of evaluation for purchase and, without the express written authorization of Sign Development Inc., may not be disclosed or duplicated, in whole or in part, for any reason. Sign Development Inc. expressly reserves all patent, copyright and other proprietary rights to this document, including all design, manufacturing, reproduction, use, and sales rights thereto. © 2011 SIGN DEVELOPMENT INC.

CUSTOMER APPROVAL

SIGN AND PRINT FULL NAME

DATE

NO. T4820

PAGE: 2 OF 5

DATE: 02.13.18SM

REV: 03.05.18GO 03.16.18GO



**863 N. MAIN ST.
FORT BRAGG, CA 95437**

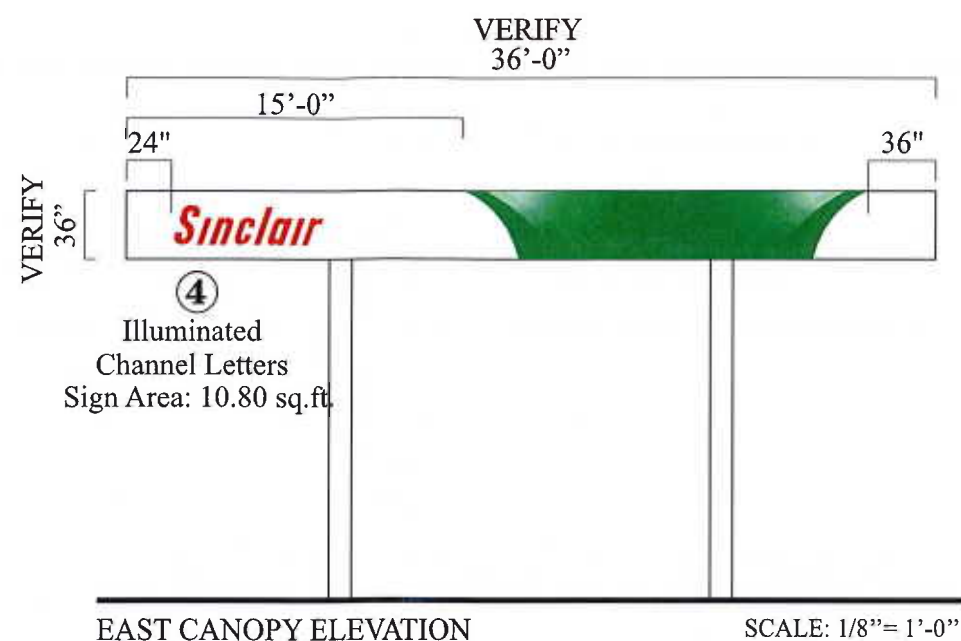
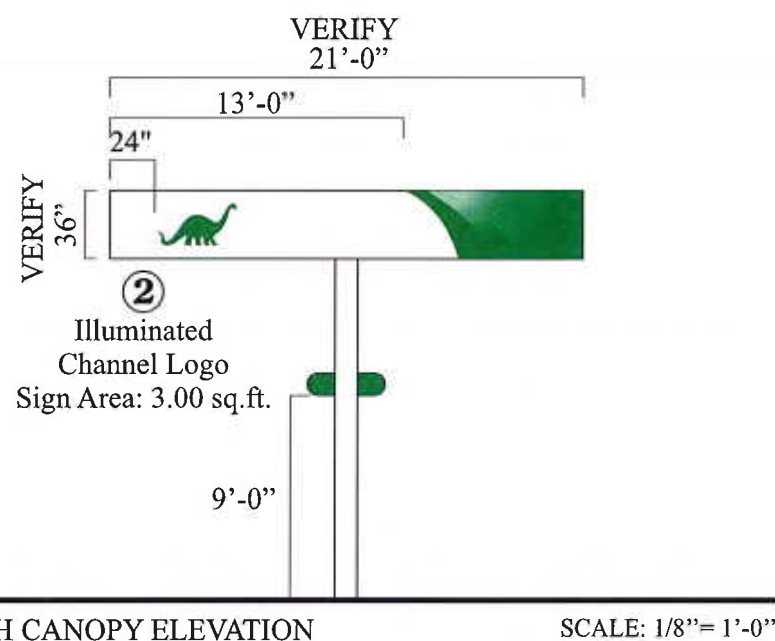

EXISTING EAST CANOPY ELEVATION

NOTES:
 PAINT CANOPY COLUMNS WHITE. **BY OWNER.**
 PAINT ALL BUMPER POLES CHARCOAL GRAY. **BY OWNER.**
 REMOVE ALL AD SIGNS FROM BUMPER POLES AND CANOPY COLUMNS.
 PROVIDE AND INSTALL NEW TANK TAGS.
 TAKE BEFORE AND AFTER PHOTOS OF EACH TAG INSTALLED.

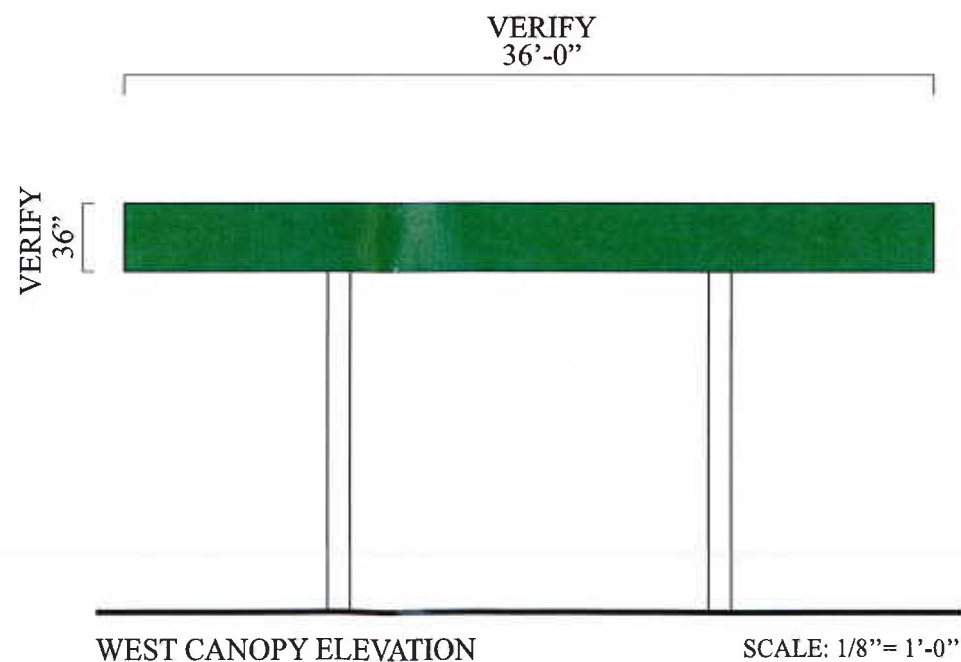
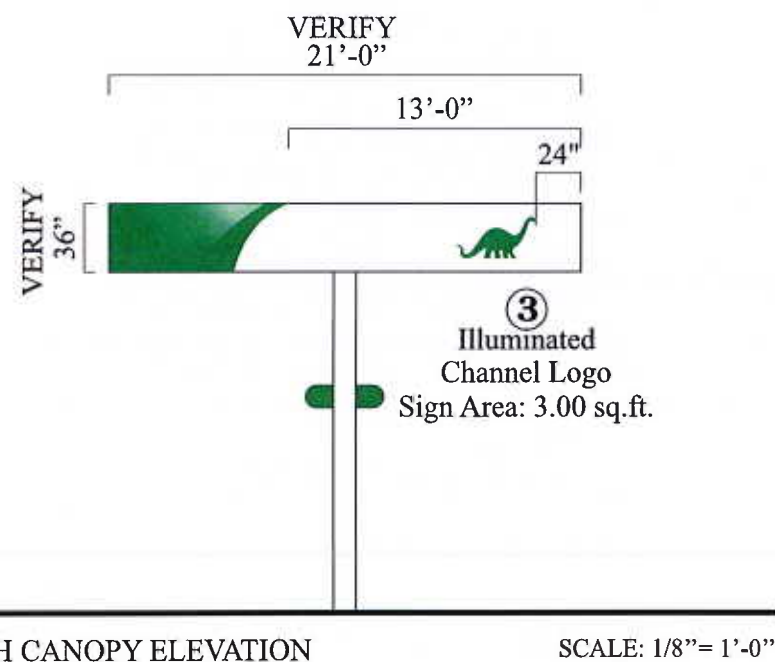

Sign Development Inc.

License #576277

Upland, CA 91786 (909) 920-5535

PROPRIETARY INFORMATION. The information disclosed in this document, including all drawings, designs and related materials, is the valuable and proprietary information of Sign Development Inc. It is provided solely for the purpose of evaluation for purchase and, without the express written authorization of Sign Development Inc., may not be disclosed or duplicated, in whole or in part, for any reason. Sign Development Inc. expressly reserves all patent, copyright and other proprietary rights to this document, including all design, manufacturing, reproduction, use, and sales rights thereto. © 2011 SIGN DEVELOPMENT INC.

CUSTOMER APPROVAL

SIGN AND PRINT FULL NAME

DATE

NO. T4820

PAGE: 3 OF 5

DATE: 02.13.18SM

REV: 03.05.18GO 03.16.18GO



863 N. MAIN ST.
FORT BRAGG, CA 95437



BUILDING PAINT TO BE HANDLED BY OWNER.

SDI TO SUPPLY AND INSTALL DINO MART CHANNEL LETTERS CENTERED ON FASCIA AND OVER ENTRANCE DOORS.

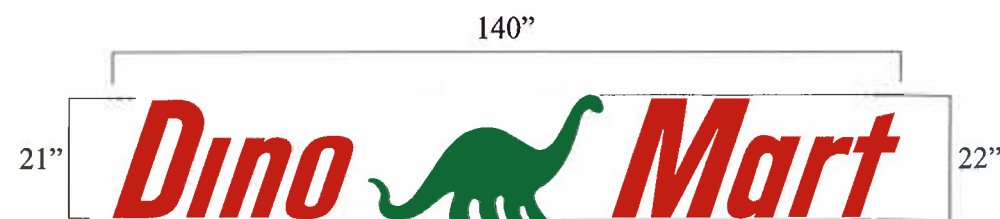

SCALE: 3/8" = 1'-0"

- ⑤ INSTALL INTERNALLY ILLUMINATED DINO MART CHANNEL LETTERS

DINO copy sign area: 6.24 sq. ft.

LOGO sign area: 6.42 sq. ft.

MART copy sign area: 7.50 sq. ft.

CHANNEL LETTER DETAILS LED ILLUMINATION

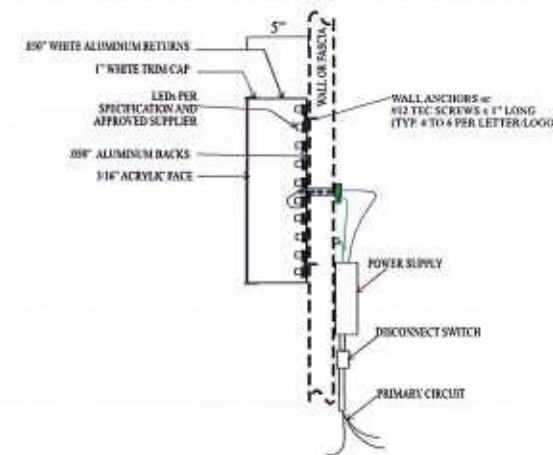

CHANNEL LETTERS
TYPICAL DETAIL (ALL LABELS REQUIRED)
ALL EQUIPMENT SHALL BE LISTED AND LABELED BY A NATIONALLY RECOGNIZED TESTING LABORATORY AND SHALL BE INSTALLED AS PER LISTING OR LABELING



Sign Development Inc.

License #576277

Upland, CA 91786 (909) 920-5535

PROPRIETARY INFORMATION. The information disclosed in this document, including all drawings, designs and related materials, is the valuable and proprietary information of Sign Development Inc. It is provided solely for the purpose of evaluation for purchase and, without the express written authorization of Sign Development Inc., may not be disclosed or duplicated, in whole or in part, for any reason. Sign Development Inc. expressly reserves all patent, copyright and other proprietary rights to this document, including all design, manufacturing, reproduction, use, and sales rights thereto. © 2011 SIGN DEVELOPMENT INC.

CUSTOMER APPROVAL

SIGN AND PRINT FULL NAME

DATE

NO. T4820

PAGE: 4 OF 5

DATE: 02.13.18SM

REV: 03.05.18GO 03.16.18GO



**863 N. MAIN ST.
FORT BRAGG, CA 95437**

NEW DISPENSERS TO BE FACTORY IMAGED
SDI TO SUPPLY AND INSTALL VALANCES & SECONDARY WARNING DECALS ONLY.
LAYOUT FOR REFERENCE ONLY.

*****VERY IMPORTANT*****
MUST NOT DRILL INTO DISPENSERS
WHEN INSTALLING VALANCES.
MUST USE EXISTING BOLTS TO
ATTACH BRACKETS AND VALANCES



1

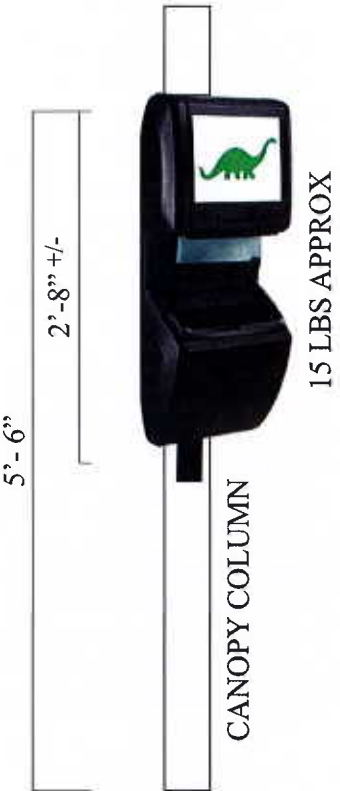

SUPPLY AND INSTALL
SINCLAIR APPROVED
WINDSHIELD AMENITIES

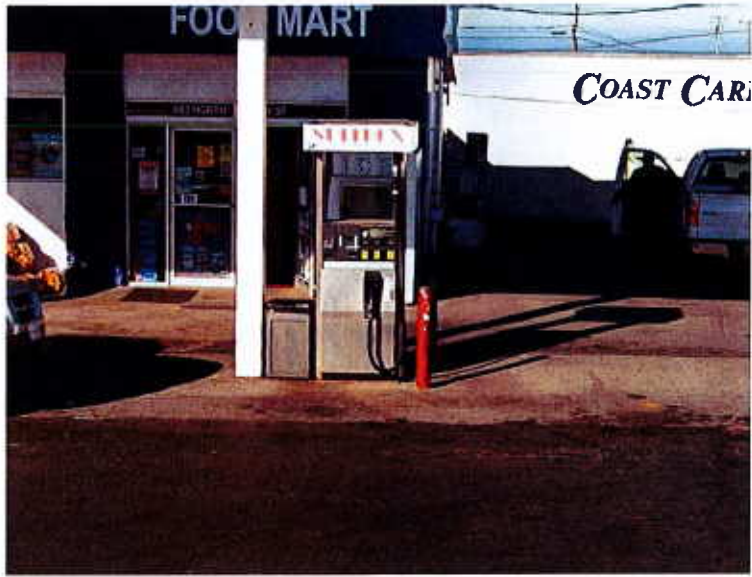

EXISTING DISPENSER



SUPPLY AND INSTALL
SINCLAIR APPROVED
TRASH CADDIES



SUPPLY AND INSTALL
SINCLAIR APPROVED
PUMP TOPPER AD FRAMES



Sign Development Inc.

License #576277

Upland, CA 91786 (909) 920-5535

PROPRIETARY INFORMATION. The information disclosed in this document, including all drawings, designs and related materials, is the valuable and proprietary information of Sign Development Inc. It is provided solely for the purpose of evaluation for purchase and, without the express written authorization of Sign Development Inc., may not be disclosed or duplicated, in whole or in part, for any reason. Sign Development Inc. expressly reserves all patent, copyright and other proprietary rights to this document, including all design, manufacturing, reproduction, use, and sales rights thereto. © 2011 SIGN DEVELOPMENT INC.

CUSTOMER APPROVAL

SIGN AND PRINT FULL NAME

DATE

NO. T4820

PAGE: 5 OF 5

DATE: 02.13.18SM

REV: 03.05.18GO 03.16.18GO



863 N. MAIN ST.
FORT BRAGG, CA 95437



21" TALL RED LED CHANNEL LETTERS
ALUMINUM CONSTRUCTION (HUNTER RED)
RED ACRYLIC (211) FACES WITH 1" RED TRIM CAP
ATTACH TO CANOPY WITH
(6) #10 GRABBER SCREWS PER LETTER (VERIFY ON SITE)



Sign Development Inc.

License #576277

Upland, CA 91786 (909) 920-5535

PROPRIETARY INFORMATION. The information disclosed in this document, including all drawings, designs and related materials, is the valuable and proprietary information of Sign Development Inc. It is provided solely for the purpose of evaluation for purchase and, without the express written authorization of Sign Development Inc., may not be disclosed or duplicated, in whole or in part, for any reason. Sign Development Inc. expressly reserves all patent, copyright and other proprietary rights to this document, including all design, manufacturing, reproduction, use, and sales rights thereto. © 2011 SIGN DEVELOPMENT INC.

CUSTOMER APPROVAL

SIGN AND PRINT FULL NAME

DATE

NO. T4820

PAGE:

DATE: 02.13.18SM

REV: 03.05.18GO 03.16.18GO



**863 N. MAIN ST.
FORT BRAGG, CA 95437**

CHANNEL LETTER DETAILS LED ILLUMINATION

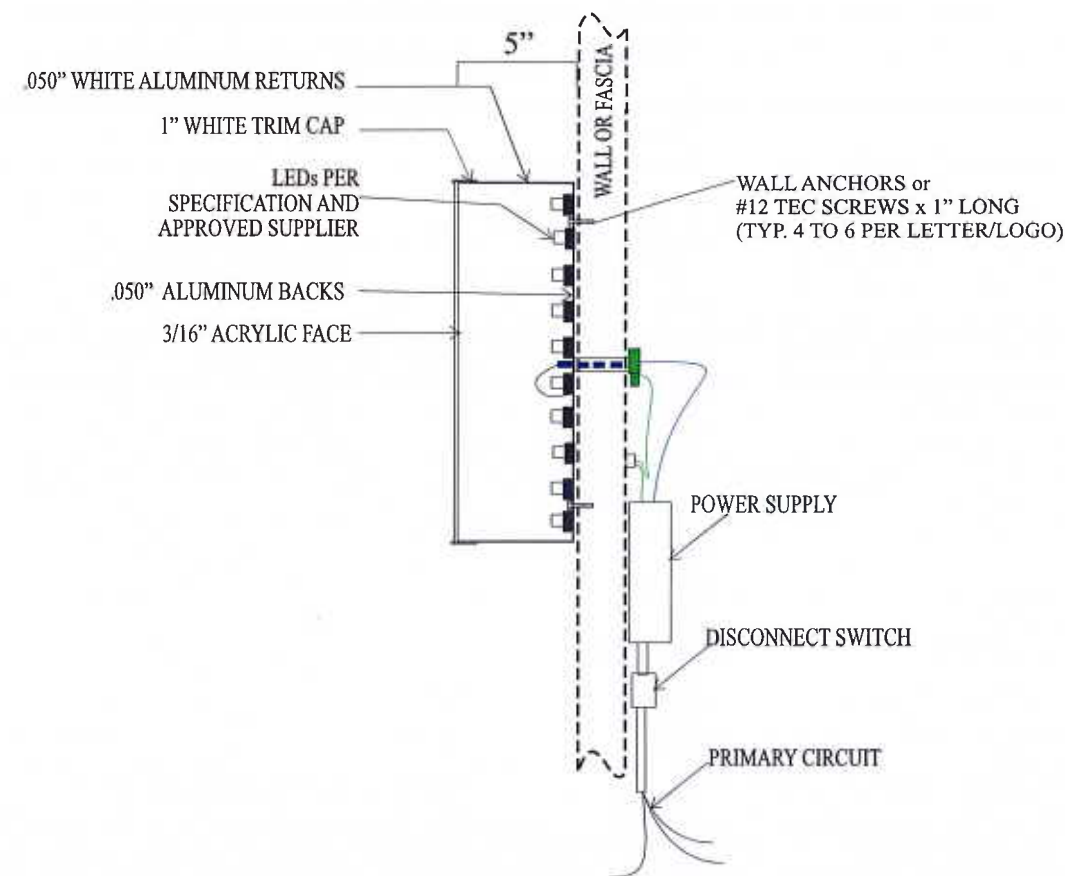

CHANNEL LETTERS
TYPICAL DETAIL (UL LABELS REQUIRED)

ALL EQUIPMENT SHALL BE LISTED AND LABELED BY A NATIONALLY RECOGNIZED TESTING LABORATORY AND SHALL BE INSTALLED AS PER LISTING OR LABELING



Sign Development Inc.

License #576277

Upland, CA 91786 (909) 920-5535

PROPRIETARY INFORMATION. The information disclosed in this document, including all drawings, designs and related materials, is the valuable and proprietary information of Sign Development Inc. It is provided solely for the purpose of evaluation for purchase and, without the express written authorization of Sign Development Inc., may not be disclosed or duplicated, in whole or in part, for any reason. Sign Development Inc. expressly reserves all patent, copyright and other proprietary rights to this document, including all design, manufacturing, reproduction, use, and sales rights thereto. © 2011 SIGN DEVELOPMENT INC.

CUSTOMER APPROVAL

SIGN AND PRINT FULL NAME

DATE

NO. T4820

PAGE:

DATE: 02.13.18SM

REV: 03.05.18GO 03.16.18GO



863 N. MAIN ST.
FORT BRAGG, CA 95437