

SAVED: 2/5/2024 10:56 AM ISLAND, PLOTTED: 2/5/2024 10:59 AM ISLAND, JASON
 \\Willis\Projects\2023\423065-NoyoCtMarineScience\Draws\423065-SITE.dwg

La-BONE-atory Landscaping Plan

The building site is home to a variety of native plant species, which will provide a beautiful landscape surrounding the new facility. We plan to enhance any disturbed areas with many of these species once the building, parking lot, and driveway are completed. Along with this plan, we will also implement a program to remove non-native and invasive species. In addition, and in accordance with the requirements, native shore pine species (15-gal. Containers) will be planted as noted on the landscaping plan.

 Shore Pine; 15 gal.

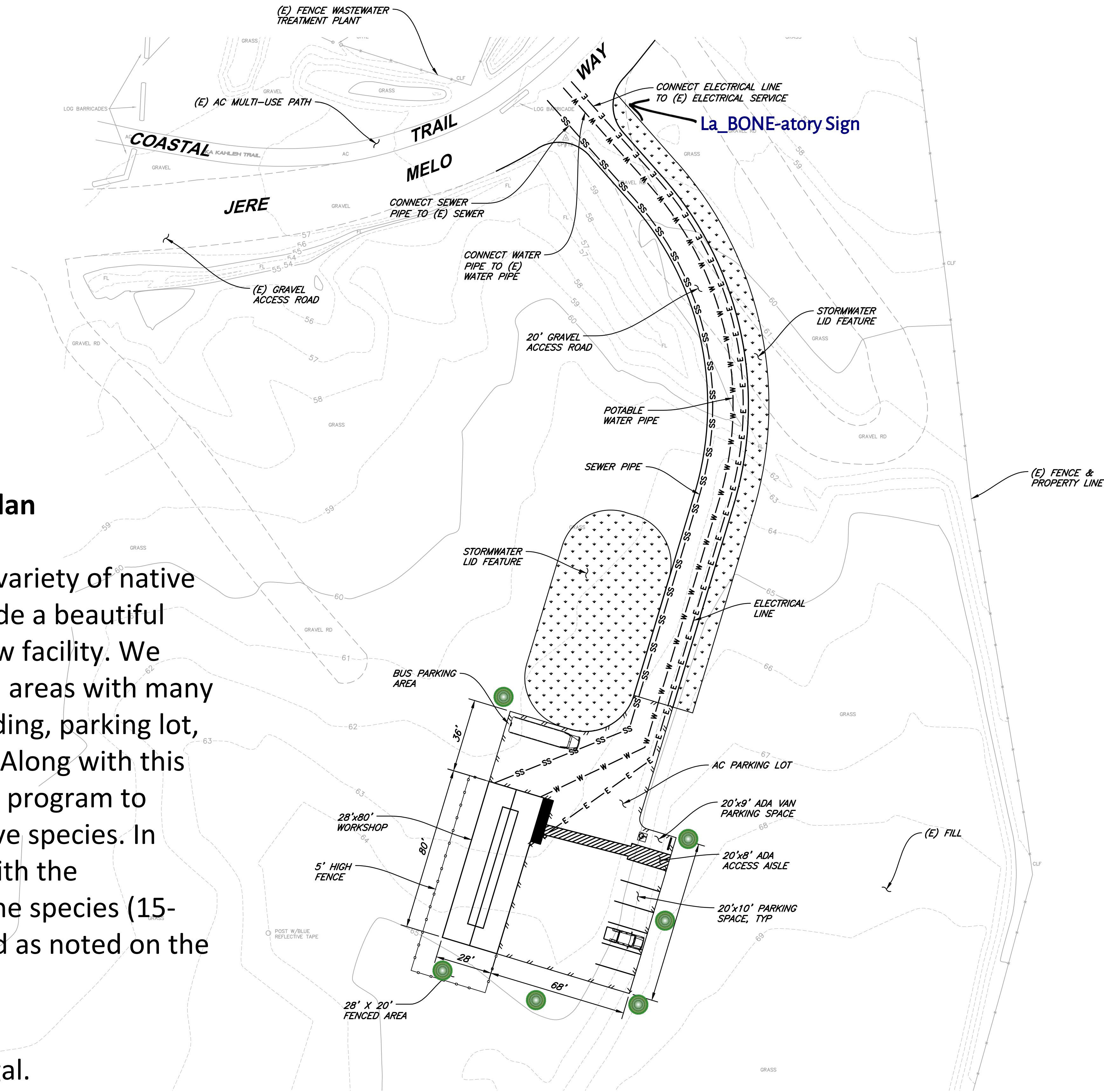

SITE PLAN
 1"=30'

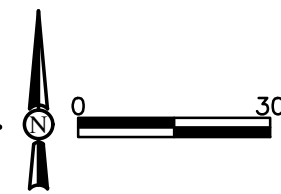

PRELIMINARY

VERIFY SCALES
 BAR IS ONE INCH ON ORIGINAL DRAWING
 IF NOT ONE INCH ON THIS SHEET ADJUST SCALES ACCORDINGLY

535 S. MAIN ST.
 WILLITS, CA 95490
 WWW.SHA-ENR.COM
 707-439-4518



| NO. | DATE | REVISION | BY |
|-----|------|----------|----|
| | | | |

NOYO CENTER FOR MARINE SCIENCE
 LA-BONE-ATORY
 FORT BRAGG, CALIFORNIA

SHEET
C1.0
 SEQ
 DATE 01/2024
 PROJ. NO.
 423065

SITE PLAN

| APVD | CHKR | CDN/JWF | JN |
|------|------|---------|----|
| | | | |