

| WALL LEGEND | |
|-------------|----------------------------|
| | (E) 1/2" THK CONCRETE WALL |
| | (E) 2X6 STUD WALLS |
| | (E) 2X4 STUD WALLS |
| | (E) 8\" CONC BLK WALL |

| SYMBOLS | |
|---------|-----------------------|
| | REFERENCE POINT |
| | PLUMBING FIXTURES |
| | SECTION NUMBER |
| | ROOM NUMBER |
| | DOORS |
| | JAM LATCHES |
| | SCAFFOLDING |
| | WINDOWS OR PARTITIONS |

NORTH

FLOOR PLAN

1/4" = 1'-0"

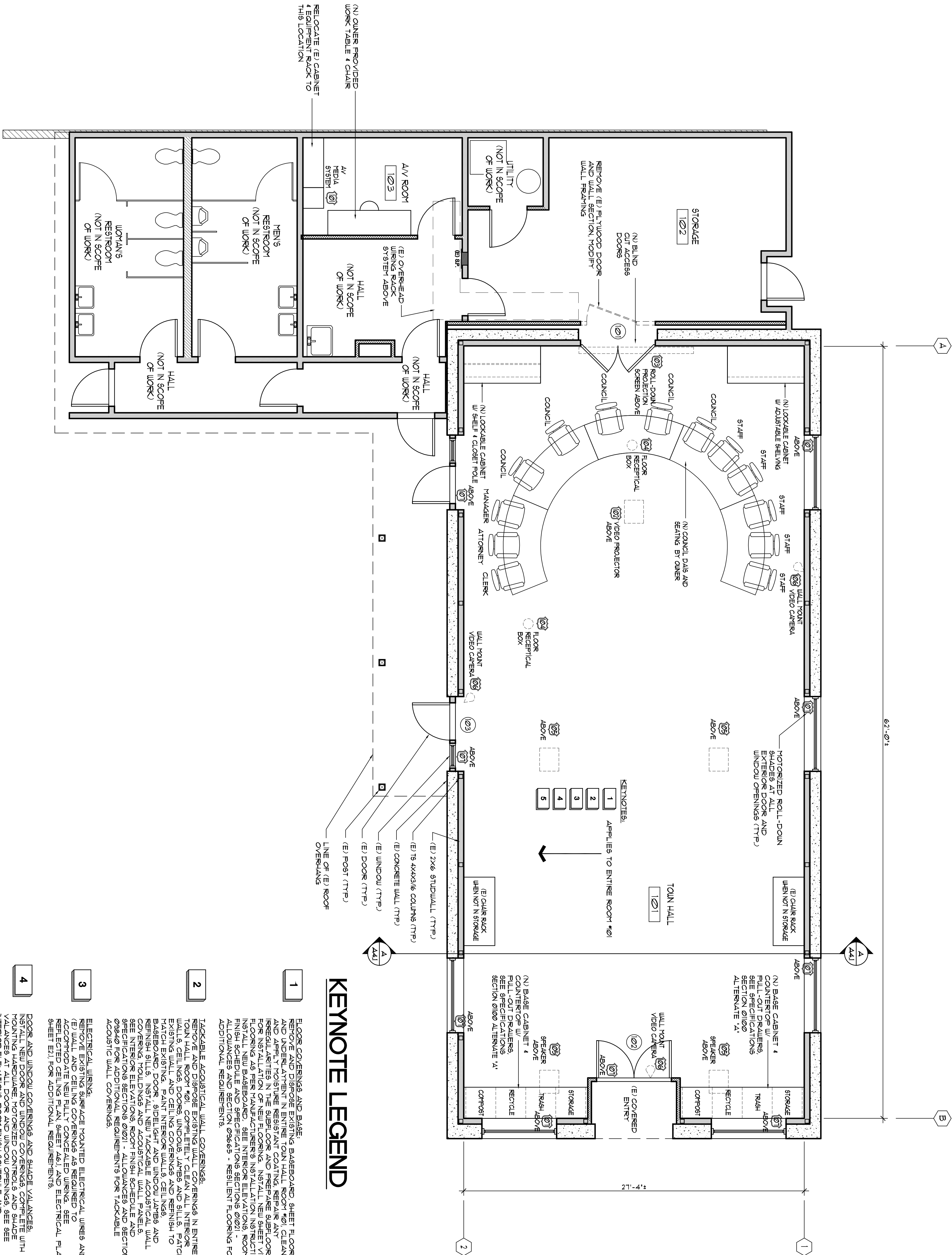

KEYNOTE LEGEND

- 1 FLOOR COVERINGS AND BASE. REMOVE EXISTING BASEBOARD, SHEET FLOORING AND UNDERLAYMENT IN ENTIRE TOWN HALL ROOM #101. CLEAN AND APPLY MOISTURE RESISTANT COATING. REPAIR ANY IRREGULARITIES IN THE SUBFLOOR AND REPAIR BASEBOARD. FLOORING AS PER MANUFACTURER'S INSTALLATION INSTRUCTIONS. INSTALL NEW BASEBOARD. SEE INTERIOR ELEVATIONS, ROOM FINISH SCHEDULE AND SECTION 0121 - ALLOWANCES AND SECTION 0965 - RESILIENT FLOORING FOR ADDITIONAL REQUIREMENTS.
- 2 TACKLE ACoustICAL WALL COVERINGS. REMOVE EXISTING CEILING ELECTRICAL WIRING IN ENTIRE ROOM #101. EXPOSE ALL CEILING COVERINGS IN ENTIRE ROOM #101. REMOVE EXISTING WALLS, DOORS, WINDOWS, JAMBES AND SILL, PATCH EXISTING WALL AND CEILING COVERINGS AND REFINISH TO MATCH EXISTING. PAINT INTERIOR WALLS, CEILINGS AND BASEBOARD. DOOR, SILL, LIGHT AND WINDOW JAMBES AND CORNICES. FINISH AND INSTALL ACoustICAL WALL COVERINGS. SEE INTERIOR ELEVATIONS, ROOM FINISH SCHEDULE AND SECTION 0940 FOR ADDITIONAL REQUIREMENTS FOR TACKLE ACoustical WALL COVERINGS.
- 3 ELECTRICAL WIRING. REMOVE EXISTING SPACE MOUNTED ELECTRICAL WIRES AND PATCH. REPAIR AND FINISH EXISTING ELECTRICAL WIRING. PATCH AND REFINISH TO MATCH EXISTING. SEE REFLECTED CEILING PLAN SHEET A6.1 AND ELECTRICAL PLAN SHEET E1.1 FOR ADDITIONAL REQUIREMENTS.
- 4 DOOR AND WINDOW COVERINGS AND SHADE VALANCES. INSTALL NEW DOOR AND WINDOW COVERINGS COMPLETE WITH MOUNTING HARDWARE. MOTORIZED CONTROLLED AND SHADE VALANCES AT ALL DOOR AND WINDOW OPENINGS. SEE SPECIFICATIONS SECTION 0100 - WINDOW AND WINDOW SHADES FOR ADDITIONAL REQUIREMENTS.
- 5 PATCHING. REPAIR AND FINISH ALL REPAIRING ACTIVITIES REQUIRING PATCHING OF EXISTING FINISHES. PATCH BACK FINISHES DISTURBED BY REPAIRING ACTIVITIES TO MATCH ADJACENT UNDISTURBED FINISHES. EXTEND AND FEATHER PATCHES SO THAT ANY IRREGULARITIES IN FINISH ARE COMPLETELY CONCEALED AND NO EVIDENCE OF FINISH REMOVAL OR REPAIR IS VISIBLE.

FLOOR PLAN

AN INTERIOR REMODEL FOR:
The City of Fort Bragg at:
TOWN HALL
 363 N. MAIN STREET
 FORT BRAGG, California 95437

SCHLOSSER, NEWBERGER ARCHITECTS
 ROBERT SCHLOSSER and TODD NEWBERGER
 435 NORTH MAIN STREET FORT BRAGG, Ca. 95437
 Phone (707) 961-0911 Fax (707) 961-0912
 www.landscape.com

DATE: 08/21/2014
 DRAWN: N
 CHECKED: RS
 SCALE: 1/4" = 1'-0"
 SHEET: A2.1

OF SHEETS: 2
 SHEET: A2.1