

W OAK ST

LEGEND USE IN DRWAING

- 1- ELECTRICAL POWER CABLE FOR LIGHTS
- 2- ELECTRICAL PANEL BOARD
- 3- POLE LIGHT FIXTURE



LED STREET LIGHT

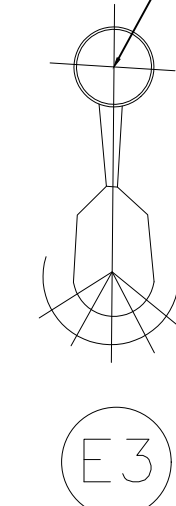

20,250 Lumens – 150 Watt – 5000 Kelvin – LED Parking Lot Fixture

4- WALL LIGHT FIXTURE



E4

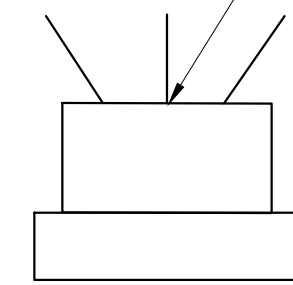

Dimension: 5.8in(L)x8.6in(H)x3.09in(D),
Lumen :2500 Watt:15 W warm light 3000K,IP65 waterproof.

5- CANOPY LIGHT FIXTURE



E5

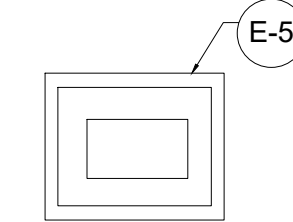

TECHNICAL SPECIFICATIONS:
Voltage: 120-277V AC
Wattage: 100 Watts
Size: 15-3/4" x 15-3/4" x 4-1/2"
Architectural UV resistant powder coat finish
Beam:120o Type V distribution
Lumens: 10,000L
IP65 Wet Location
Color Temperature(CCT): 5,000K Daylight
Operating Temp: -30oC to +50oC
Operating Humidity: 20% to 90% RH

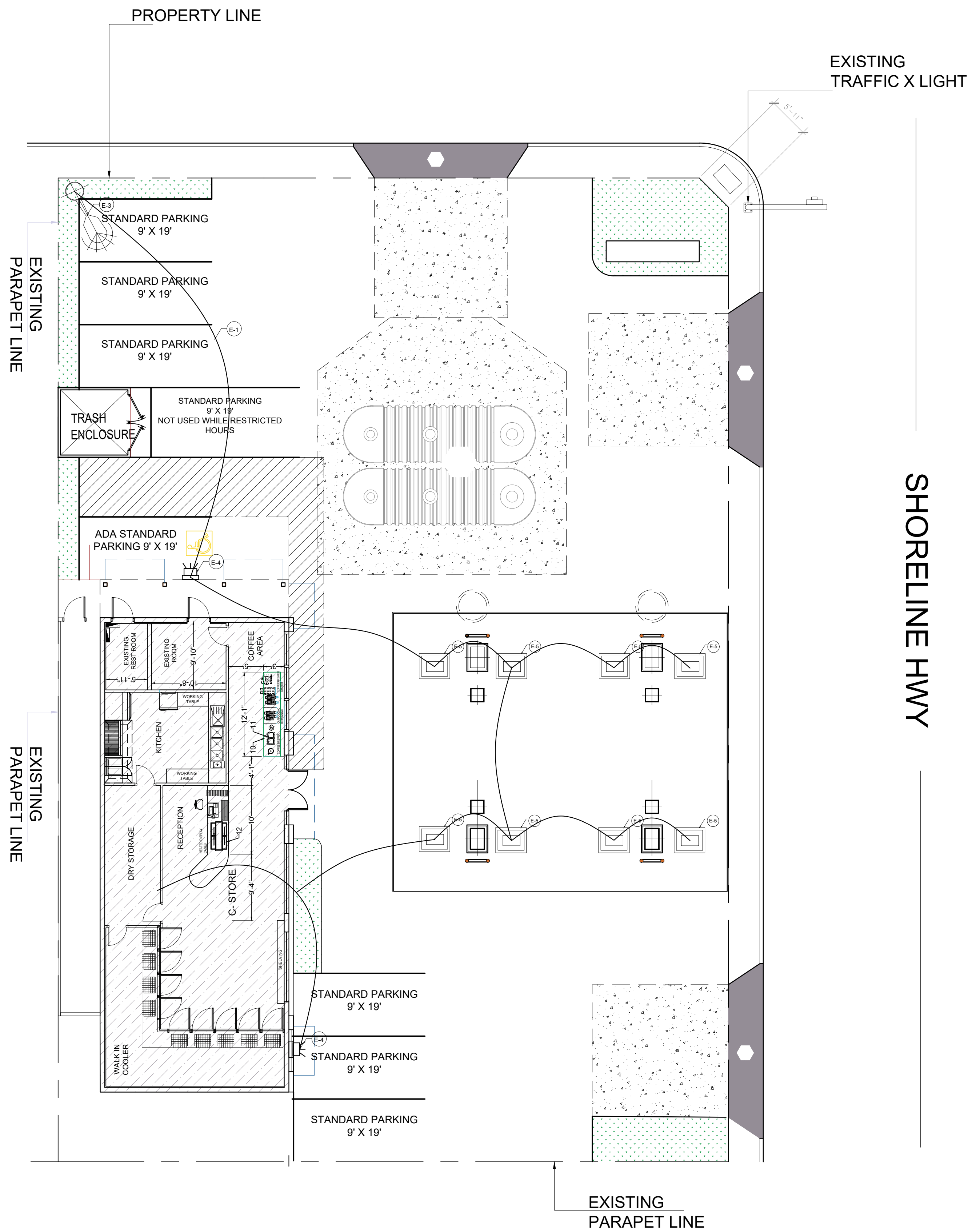
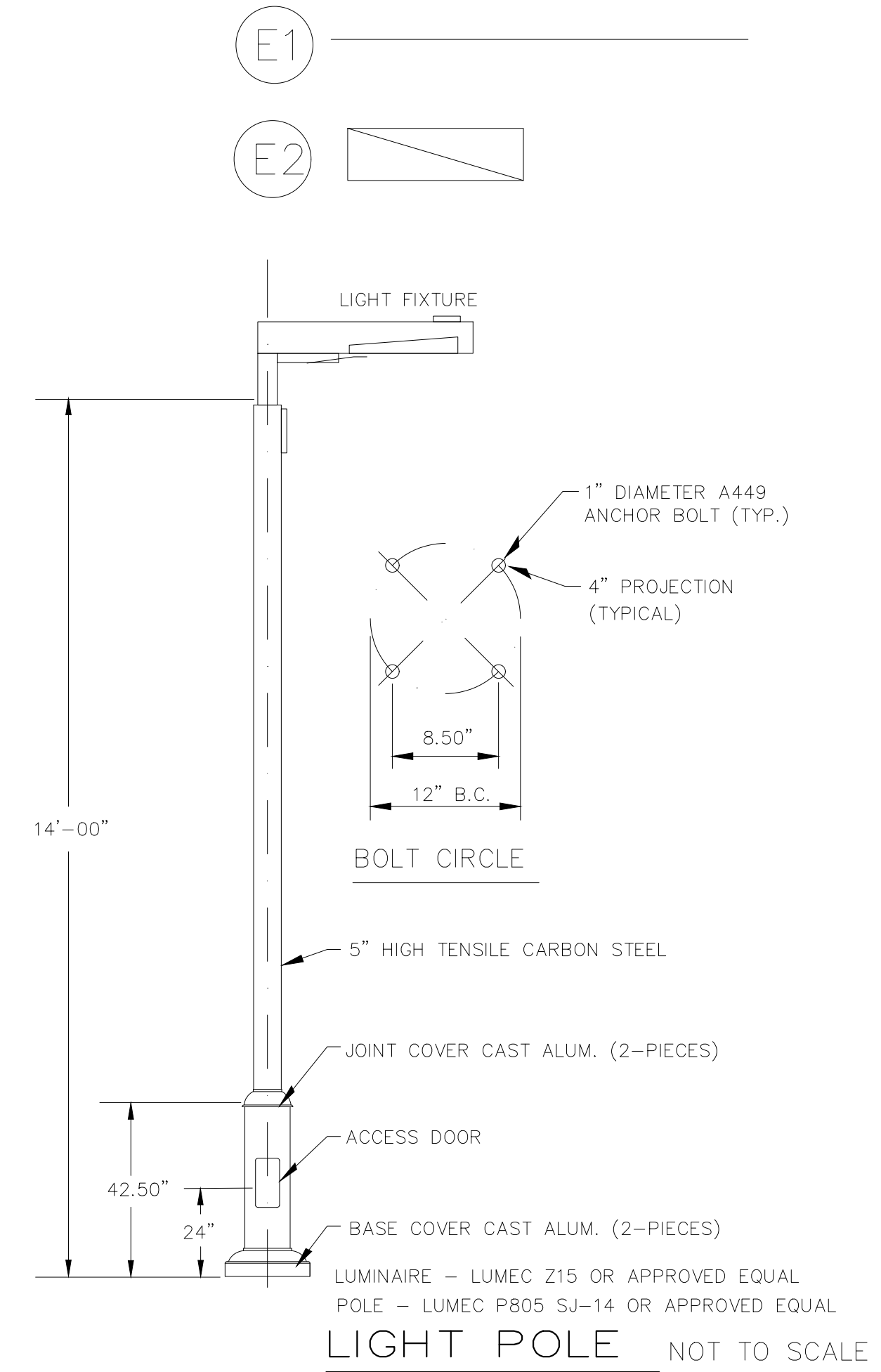

E-1.0 Electrical Site PLAN
SCALE: 1"=10'-0"

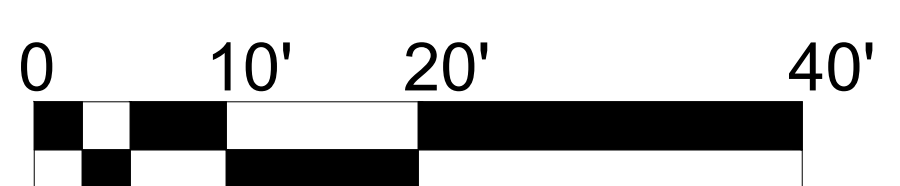

PROJECT DIRECTOR:
FARAH CHAUDHARY
PHONE: +1 (916) 793-4048
Farah@theboulevard.us
PROJECT MANAGER:
M HAMAYOON BAHEZ
+1 (916) 477-0102
hamayoon@theboulevard.us

ARCHITECT OF RECORD:
BOULEVARD Construction
4080 TRUXEL ROAD, SUITE 100,
SACRAMENTO, CA. US 95834
Website - <https://theboulevard.us>
Call - +1 (916) 336-4200
FAX NO - (916) 814-2215
Email - info@theboulevard.us

PROJECT:
105 S MAIN ST, FORT BRAGG, CA 95437-4207
Assessor Parcel # 008-161-10-00

REVISIONS:	DATE:	DESCRIPTION	BY:

CURRENT ISSUE DATE:
02-05-24
ISSUED FOR:
CONTROL NO.:

DRAWN BY: **BOULEVARD**
CHECKED:
APPROVED:

SHEET TITLE:
STREET LIGHT PLAN

SHEET #
E-1.0

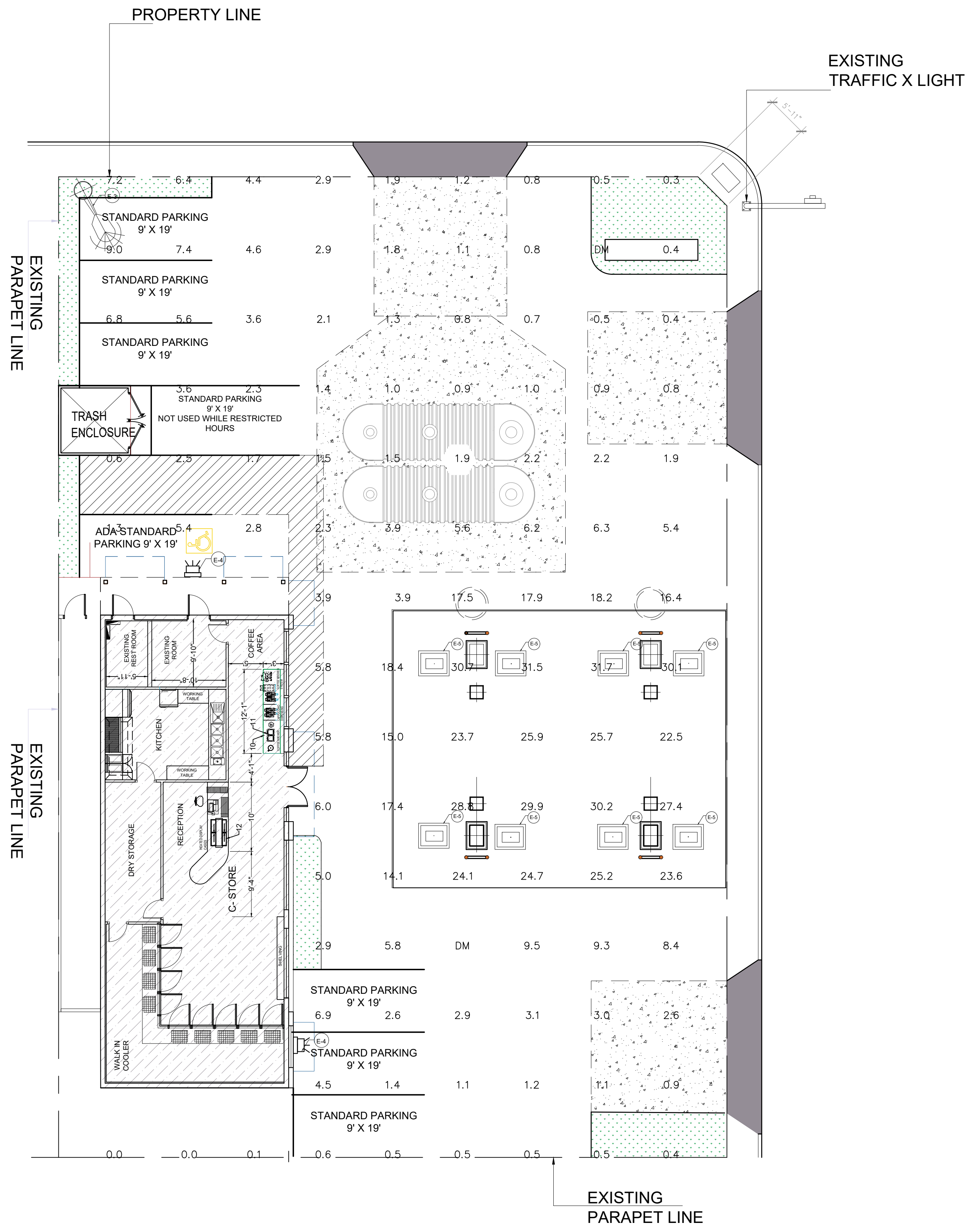

LUMINAIRE SCHEDULE

CALLOUT	SYMBOL	LAMP	DESCRIPTION	BALLAST	MOUNTING	MODEL	VOLTS	NOTE	QUANTITY	TOTAL LUMENS
CANOPY LIGHT		(1) 100W .	TG-CP3808S100W(4000K)	ELECTRONIC	CEILING	TG PHOTOELECTRIC TECHNOLOGY CO LTD.	120V 1P 2W		8	11176
POLE LIGHT		(1) 150W .	LED	ELECTRONIC	POLE	MESTER LED LTD. MAL05150W27V50KDSQT3	120V 1P 2W		1	21000
WALL LIGHT		(1) 15W 90 white LEDs, one LED board	Surface mounted, cast aluminum housing, formed white enameled aluminum reflector, clear linear prismatic lens with frosted side sections.	ELECTRONIC	WALL	Topaz Lighting Corp. F-MPC/20W/CTS/BZ-96 - 4000K Setting	120V 1P 2W	One HB-LPG020G-52 LED Driver	2	2500

GENERAL PHOTOMETRIC SCHEDULE

AVERAGE FOOT-CANDLES	7.54
MAXIMUM FOOT-CANDLES	31.7
MINIMUM FOOT-CANDLES	0.0
MINIMUM TO MAXIMUM FC RATIO	0.00
MAXIMUM TO MINIMUM FC RATIO	31.75 / 0.00
AVERAGE TO MINIMUM FC RATIO	7.54 / 0.00

E-2.0 PHOTOMETRIC PLAN
SCALE: 1"=10'-0"

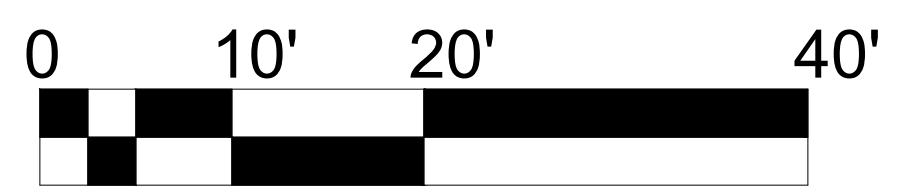

PROJECT DIRECTOR:
 FARAH CHAUDHARY
 PHONE: +1 (916) 793-4048
 Farah@theboulevard.us

PROJECT MANAGER:
 M HAMAYOON BAHEZ
 +1 (916) 477-0102
 hamayoon@theboulevard.us

ARCHITECT OF RECORD:
BOULEVARD
 Construction
 4080 TRUXEL ROAD, SUITE 100,
 SACRAMENTO, CA, US 95834
 Website: https://theboulevard.us
 Call: +1(916) 330-4200
 FAX NO: (916) 914-2215
 Email: Info@theboulevard.us

PROJECT:
 105 S MAIN ST, FORT
 BRAGG, CA 95437-4207

Assessor Parcel # 008-161-10-00

REVISIONS:

DATE:	DESCRIPTION	BY:

CURRENT ISSUE DATE:
02-05-24

ISSUED FOR :

CONTROL NO' :

DRAWN BY: **BOULEVARD**

CHECKED:

APPROVED:

SHEET TITLE
PHOTOMETRIC PLAN

SHEET #
E-2.0